

# TECHNICAL DATA



## LITHIUM SULPHUR DIOXIDE G62/1 SERIES

Size (ASA Designation) .. N/A  
 Length..... 141.0mm  
 Diameter..... 41.7mm  
 Weight ..... 300g  
 Construction..... Hermetically sealed, all welded steel casing, incorporating a safety vent and a glass to metal seal

Voltage ..... Nominal 3.0 volts  
 Typical operating Voltage ..... 2.65 – 2.80 volts  
 Capacity (1000mA – 2.0v).....34Ah  
 50% capacity achieved at .. 8000mA  
 Temperature range..... -50 C + 70 C  
 Shelf life at ambient temperature ... 10 years  
 Self discharge..... Typical 2% p.a.

### STANDARD TERMINATIONS

(OTHERS AVAILABLE ON REQUEST)

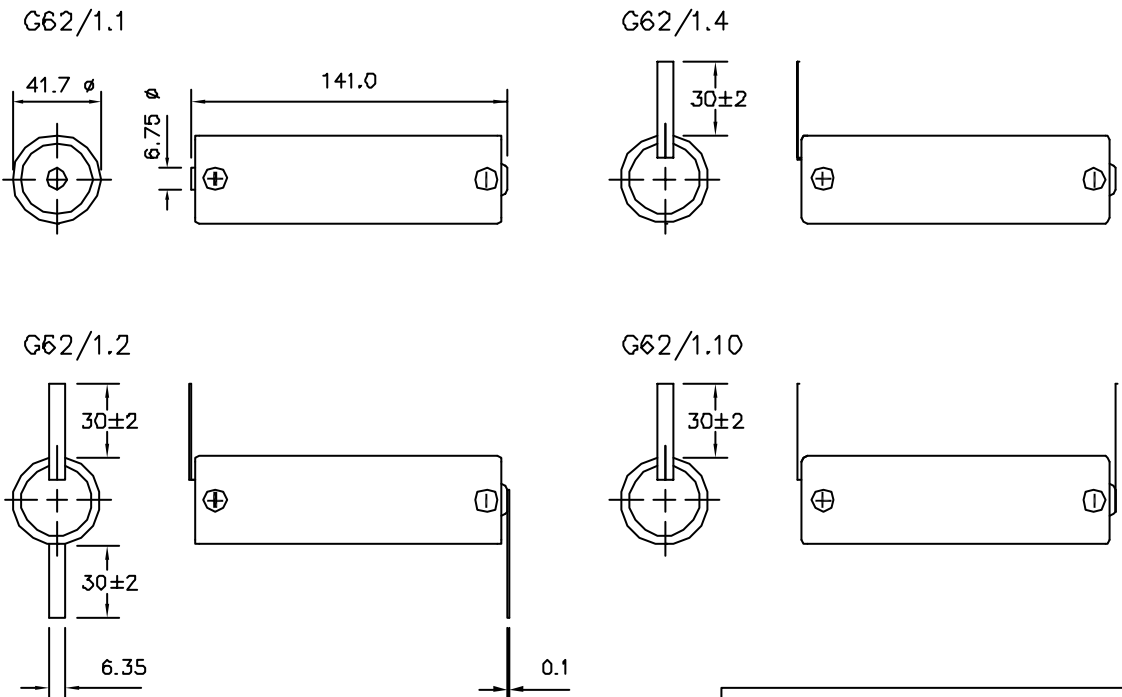

Typical order code example  
 G62 / 1 .1  
 CELL SIZE    DISCHARGE RATING    TERMINATION STYLE

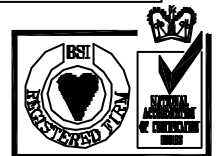

# TYPICAL ELECTRICAL PERFORMANCE

Typical discharge characteristics ° at +20 C.

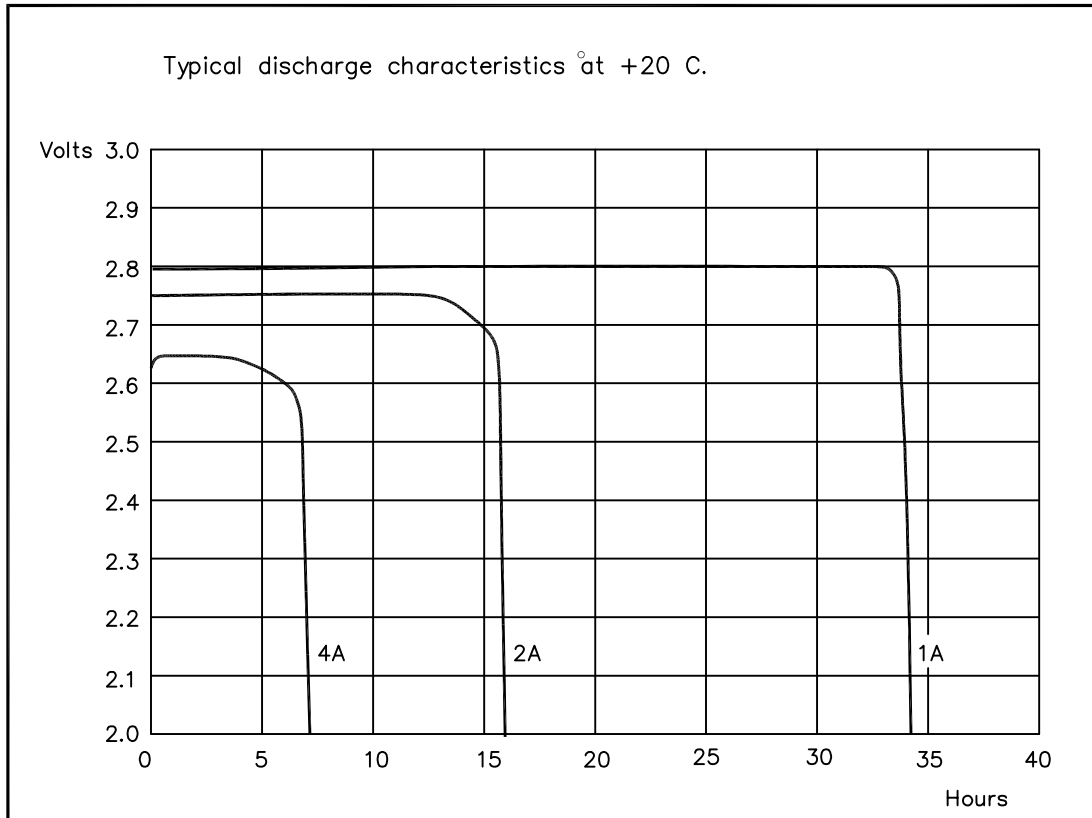

Typical discharge characteristics on a 2A constant current load

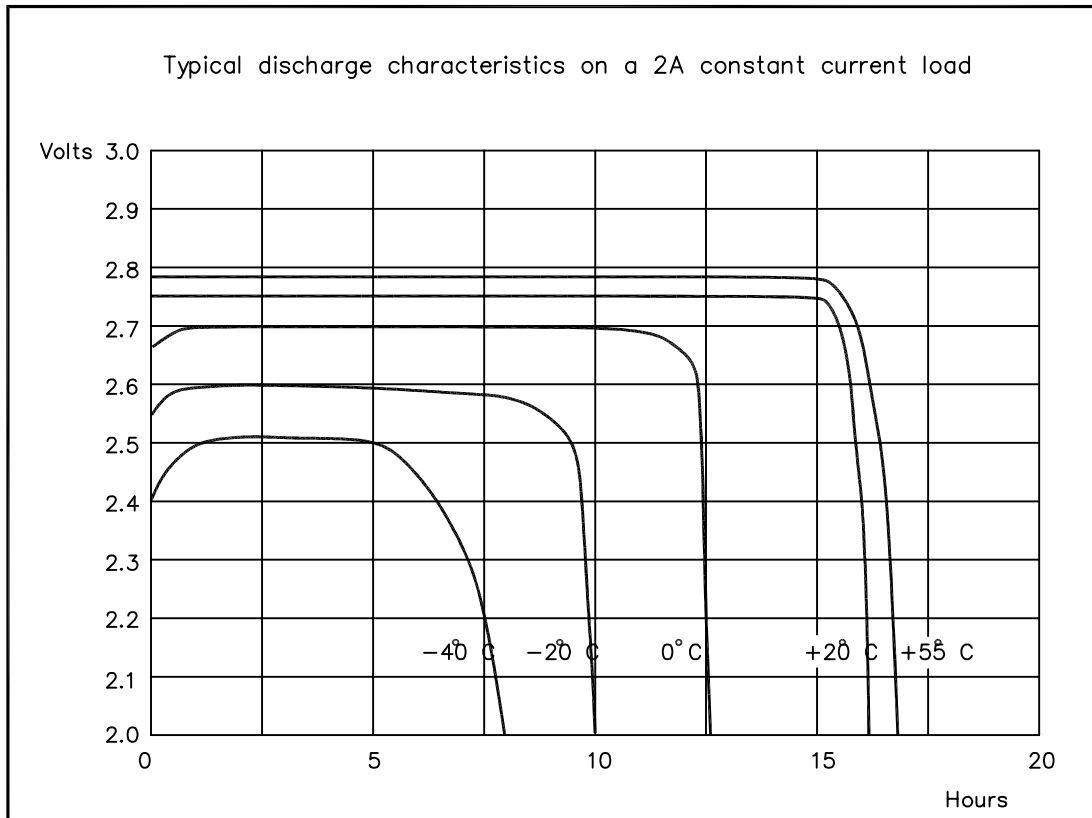

SAFT LTD, RIVER DRIVE, SOUTH SHIELDS, ENGLAND, TEL: 44 (0)191 4561451, FAX: 44 (0) 191 4566383.

SAFT LTD, adopt a policy of constant improvement and reserve the right to change specifications without notice.